



# SERIES SRL15

Spring Regulator, Low Pressure,  
Ported - (DN15)



**YOUR CREATIVE ENGINEERING PARTNER**

# SERIES SRL15

## Spring Regulator, Low Pressure, Ported - (DN15)

The Series SRL15 is configurable Spring Regulator offering performance and reliability, optimised for your application.

The SRL15 provides a hassle free solution to set and adjust pressure, focusing on ensuring delivery pressure is stable regardless of variations in ambient temperature.

The Series SRL15 can be configured to meet the requirements of multiple pressure reduction applications.

## HIGHLIGHTS

- > Stable in high-pressure drop / low flow applications
- > Fail Safe In-field repairs made easy with a range of hassle free spares and aftermarket offerings.

## IDEAL USES

- > Mission Critical Pressure Reduction Applications.
- > Test Systems including those requiring a fast response during start up and shut down.
- > HP Air Systems (Maritime, Industrial).



SRL15 – SPRING REGULATOR



SRL15 – SPRING REGULATOR (WITH EXTERNAL SENSING)

INLET:  
**420**  
barg  
(6000 psig)

OUTLET  
OPTIONS  
**0-10** barg  
(0-145 psig)  
**0-20** barg  
(0-290 psig)

# Features and Specifications

## 1. Handwheel for Ease of use

The SRL's ergonomic design Handwheel allows for a smooth increase/reduction in outlet pressure.

## 2. Locked outlet available

SRL 15 can be supplied with factory set locked outlet pressure  
The integrated external sensing function allows the SRL15 to deliver less droop under flow (i.e. at pressures close to the original set pressure).

## 3. Connections

Connections via 1/2" BSP or 1/2" NPT Ports.

## 4. Four-Port Design

The Series SRL15 Pressure Control Regulator is provided with four process / accessory ports, allowing the SRL15 to be configured to meet your application requirements.



# Product Specification Data

Series SRL15	
Inlet Pressure	420 barg (6000 psig)
Cv	0.08
Maximum Outlet Pressure	0 - 10 barg (0 - 145 psig)   0 - 20 barg (0 - 290 psig)
Sensing Type	Internal / External
Service Temperature Range (HNBR – Standard Option)	-40°C to +80°C
Service Temperature Range (FKM/Viton)	-20°C to +150°C
Service Temperature Range (EPDM)	-20°C to +150°C
Seat and Outboard Leakage (standard)	Bubble Tight
Body / Material	Stainless Steel 316L

### Required Information

When placing an enquiry, please advise the following:

- > Inlet Pressure Range
- > Outlet Pressure Range
- > Flow Rate Range
- > Fluid Temperature Range
- > Ambient Temperature Range
- > Fluid Type
- > Application Details
- > Any Special Requirements (materials, etc)



## Series DFR Dome Regulators

The Series SRL15 can also be configured with Hale Hamilton's Series DFR Dome Regulators and Manifolds for integrated pressure control solutions.

For more information please see the Series DFR product data sheet.

# Typical Configurations

The Series SRL15 Pressure Control Regulator is provided with four process / accessory ports, allowing the SRL15 to be configured to meet your application requirements.

For further information, configuration assistance and additional options, please contact [sales@halehamilton.com](mailto:sales@halehamilton.com).

Our Sales team will be happy to help you.

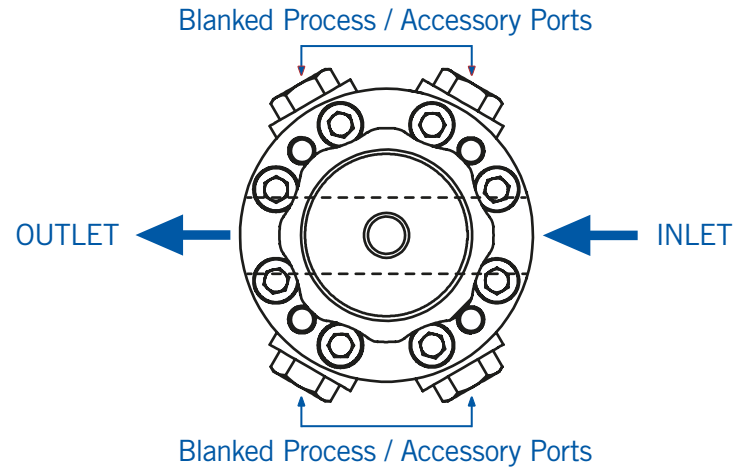

# Enquiries and Orders

Your SRL15 Pressure Control Regulator can be selected using the ordering system set out below.

Alternatively, you can contact Hale Hamilton sales at ([sales@halehamilton.com](mailto:sales@halehamilton.com)) with information on fluid type, pressures, flow rates, fluid temperatures and the application.

'SR' 'L' '15' '1' '1' 'H' 'K' 'L' '01'

Type	Pressure Rating	Size	Port Type	Pressure Range	Elastomer Type	Seat Material	Locking Feature	Special Feature
Mandatory	Mandatory	Mandatory	Mandatory	Mandatory	Mandatory	Mandatory	Omit If Not Used	Omit If Not Used
'SR' - Spring Regulator	'L' - Low Pressure	'15' - DN15	1=G	'1' - 0 - 10 barg (0 - 145 psig)	'H' - HNBR	'K' - PCTFE	'L' - Locking	'XX' - Special Features (alternative materials etc) New codes allocated on client request.
			2=NPT	'2' - 0 - 20 barg (0 - 290 psig)	'F' - FKM (Viton)	'P' - PEEK		'E' - External Sensing
					'E' - EPDM	'N' - NYLATRON		

# Installation Dimensions

All Dimensions in mm.

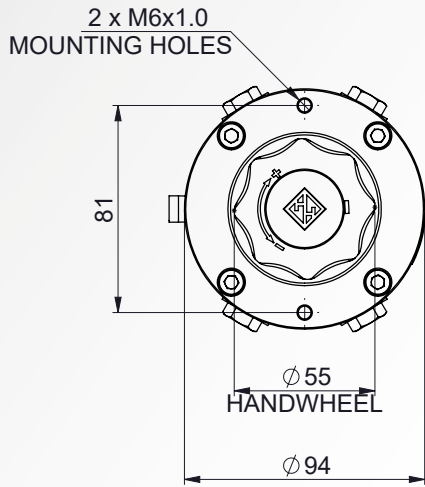

Mounting Details

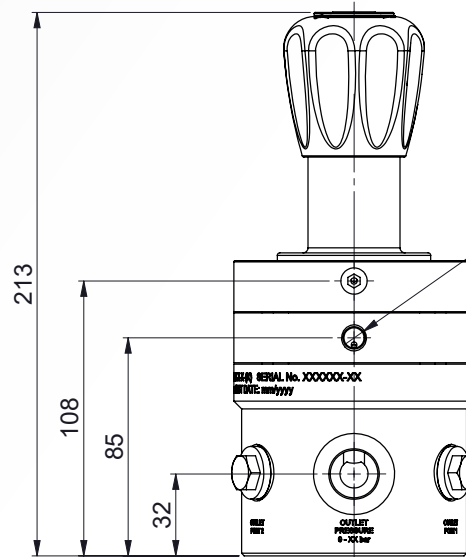

With External Sensing

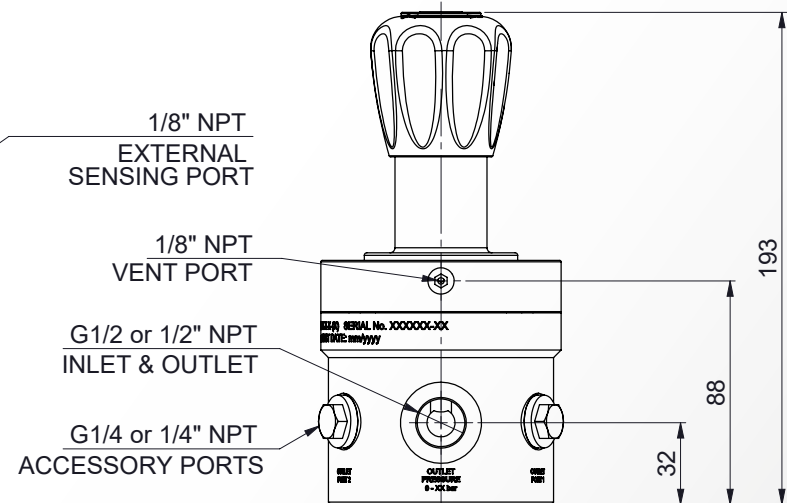

Without External Sensing

Dimensions	A	B	C	D	E	F	G	H	I	J	K	Weight
With External Sensing	213	108	33	85	81	94	2 x M6x1.0	104	1/2" NPT	G 1/4" / 1/4" NPT	1/8" NPT	5.6 kg
Without External Sensing	193	88	-	-	-	-	-	-	-	G 1/2" / 1/2" NPT	-	4.8 kg